

MIDA测头应用附件

马波斯提供一系列测头附件，为各种机床和应用组成测量系统。

安装座和加长杆

各种附件满足Mida 测头在各种应用场合的使用，它们的应用使测头适应于机床内各种测量的苛刻情况。

探针

根据Marposs测量领域的经验而生产的满足各种需求的探针：

- 工件测量和对刀用硬质合金或红宝石接触球或面
- 不锈钢、硬质合金或碳纤维探针杆
- 特殊定制

如何挑选探针得到高精度

- 1) 尽可能短的探针
- 2) 长探针用陶瓷杆
- 3) 尽量不用加长杆
- 4) 选用适当直径的球
- 5) 用磁性装夹时，选用红宝石球探针
- 6) 车床选用金属杆

工件测量用探针

陶瓷杆和硬质合金球组成的直杆探针

L mm (inch)	B mm (inch)	S mm (inch)	订货号
35 (1.38)	6 (.23)	4 (.16)	3191910872
40 (1.57)	6 (.23)	4 (.16)	3191910873
45 (1.77)	6 (.23)	4 (.16)	3191910874
50 (1.97)	6 (.23)	4 (.16)	3191910875
70 (2.75)	7 (.27)	5 (.19)	3191910871
75 (2.95)	6 (.23)	4 (.16)	3191910870
100 (3.94)	6 (.23)	4 (.16)	3191910865
100 (3.94)	10 (.39)	4 (.16)	3191929210
125 (4.92)	7 (.27)	5 (.19)	3191929200
150 (5.90)	7 (.27)	5 (.19)	3191910860

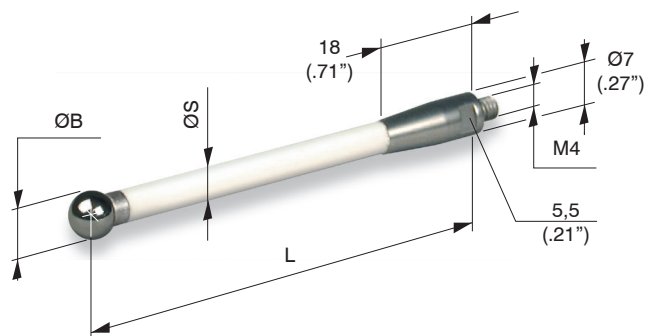

钢杆和硬质合金球组成的直杆探针

L mm (inch)	B mm (inch)	S mm (inch)	订货号
25 (.98)	6 (.23)	4 (.16)	3191910811
30 (1.18)	6 (.23)	4 (.16)	3191910804
35 (1.38)	6 (.23)	4 (.16)	3191910805
40 (1.57)	6 (.23)	4 (.16)	3191910810
50 (1.97)	6 (.23)	4 (.16)	3191910815
70 (2.75)	6 (.23)	4 (.16)	3191910825
75 (2.95)	6 (.23)	4 (.16)	3191910830
80 (3.14)	6 (.23)	4 (.16)	3191910835
100 (3.94)	6 (.23)	4 (.16)	3191910840
150 (5.90)	7 (.27)	5 (.19)	3191910845

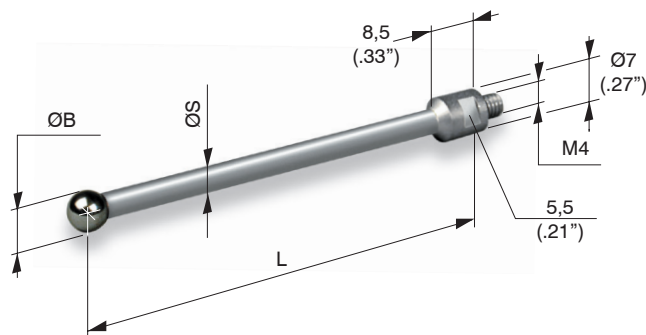

红宝石球直杆探针

L mm (inch)	B mm (inch)	S mm (inch)	P mm (inch)	杆	订货号
19 (0.75)	2 (.08)	1.2 (.05)	11 (.43)	TC	3191910911
19.5 (0.77)	1 (.04)	.8 (.03)	15 (.59)	TC	3191910910
30 (1.18)	3 (.12)	2 (.08)	9 (.04)	TC	3191910912
30 (1.18)	4 (.15)	3 (.12)	9 (.04)	TC	3191910914
30 (1.18)	4 (.15)	3 (.12)	9 (.04)	CE	3191910868
50 (1.97)	3 (.12)	2 (.08)	9 (.04)	TC	3191910913
50 (1.97)	4 (.15)	3 (.12)	9 (.04)	CE	3191910866
50 (1.97)	6 (.23)	4.5 (.18)	16 (.63)	CE	3191910818
100 (3.94)	6 (.23)	4.5 (.18)	16 (.63)	CE	3191910819
150 (5.90)	6 (.23)	4 (.15)	16 (.63)	CFK	3191910915

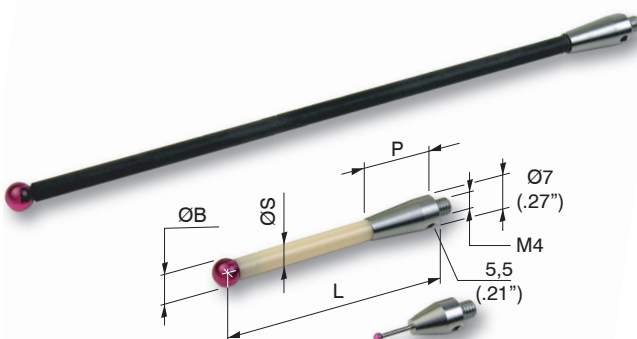

CE = 陶瓷
TC = 硬质合金
CFK = 碳纤维

Ø6硬质合金球头钢杆曲柄探针

A mm (inch)	B mm (inch)	订货号	配合弱保护
30 (1.18)	50 (1.97)	3191910876	1015051100
35 (1.38)	40 (1.57)	3191910877	1015051100
40 (1.57)	35 (1.38)	3191910878	1015051100
40 (1.57)	40 (1.57)	3191910879	1015051100
40 (1.579)	50 (1.97)	3191910880	1015051100
40 (1.57)	60 (2.36)	3191910881	1015051100
50 (1.97)	35 (1.38)	3191910882	1015051100
50 (1.97)	50 (1.97)	3191910883	1015051100
50 (1.97)	60 (2.36)	3191910884	1015051100
60 (2.36)	60 (2.36)	3191910885	1015051100

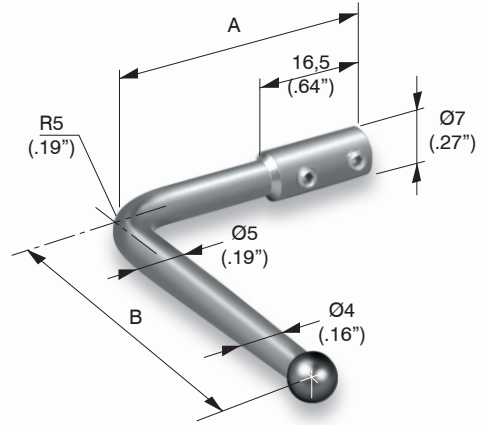

硬质合金圆盘直杆盘型探针

L mm (inch)	D mm (inch)	S mm (inch)	H mm (inch)	R mm (inch)	订货号
8,5 (.33)	30 (1.18)	7 (.27)	3 (.11)	2 (.07)	3191927830
10,5 (.41)	14 (.55)	7 (.27)	4 (.15)	0	3191927863
21 (.82)	15 (.59)	4 (.15)	8 (.31)	0	3191927860
50 (1.97)	15 (.59)	4 (.15)	3 (.11)	2,5 (.09)	3191927827

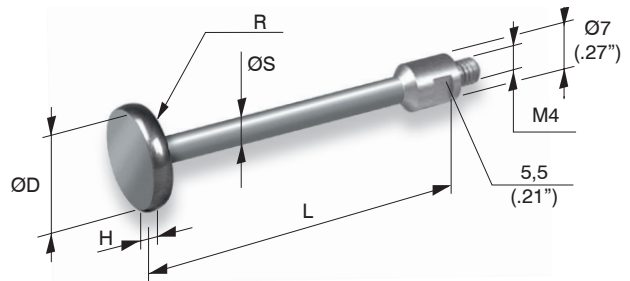

20mm长硬质合金钢球钢杆直探针

B mm (inch)	S mm (inch)	L1 mm (inch)	订货号
1 (.04)	0,75 (.03)	4 (.16)	3191910806
2 (.08)	1,50 (.06)	7 (.27)	3191910807
4 (.16)	3 (.12)	10 (.39)	3191910808
6 (.24)	4 (.16)	11,5 (.45)	3191910803
8 (.32)	6 (.23)	11,5 (.45)	3191910809

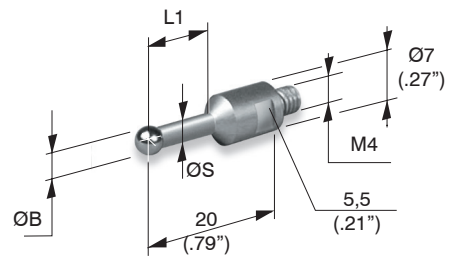

加长杆

L mm (inch)	订货号
10 (.39) steel	1019108026
15 (.59) steel	1019108027
20 (.79) steel	1019108028
25 (.98) steel	1019108024
30 (1.18) steel	1019108029
30 (1.18) ceramic	2019108005
50 (1.97) steel	1019108025

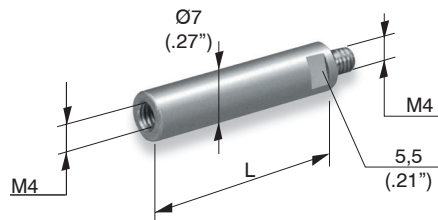

对刀仪用探针

方头硬质合金钢杆直探针

L mm (inch)	方头 mm (inch)	订货号	配合弱保护
17 (.66)	10x10x4 (.39x.39x.16)	3191982502*	1019825075
17 (.66)	20x20x4 (.78x.78x.16)	3191927855*	1019825075
30,5 (1.20)	6x6x6 (.23x.23x.23)	3191910886	1015051100
35,5 (1.40)	6x6x6 (.23x.23x.23)	3191910887	1015051100
47,5 (1.87)	6x6x6 (.23x.23x.23)	3191910888	1015051100
60,5 (2.38)	6x6x6 (.23x.23x.23)	3191910889	1015051100
94,5 (3.72)	6x6x6 (.23x.23x.23)	3191910890	1015051100

(* 11,5 (.45") instead of 16,5 (.64")

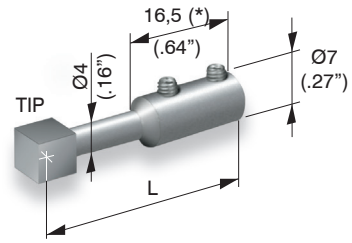

方头硬质合金钢杆曲柄探针

A mm (inch)	B mm (inch)	订货号 mm (inch)	订货号	配合弱保护
17 (.66)	32 (1.25)	10x10x4 (.39x.39x.16)	3191982506	1019825075
16,5 (.64)	32 (1.25)	6x6x6 (.23x.23x.23)	3191982507	1019825075

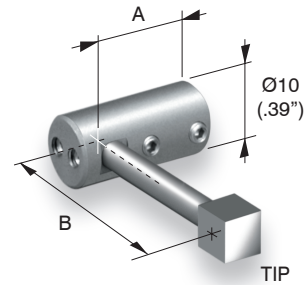

圆盘硬质合金钢杆曲柄探针

L mm (inch)	B mm (inch)	D mm (inch)	H mm (inch)	订货号	配合弱保护
17 (.66)	32 (1.25)	15 (.59)	3 (.11)	3191982508	1019825075
17 (.66)	32 (1.25)	10 (.39)	6 (.23)	3191982510	1019825075

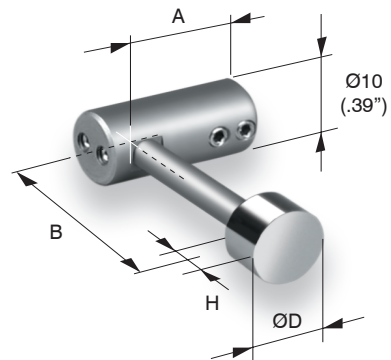

TS30/OTS30 用硬质合金探针

D mm (inch)	H mm (inch)	订货号	配合弱保护
39 (1.54)	7,5 (.30)	3192787701	1027877508



探针附件

弱保护

描述 mm (inch)		订货号
L = 15 mm (.59")	A	1019108005
L = 8 mm (.31")	B	1019108038
用于顶丝安装的探针	C	1015051100
T18对刀仪用	D	1019825075
	E	1044957100
转接板(杆)用螺丝	Z	1019108004

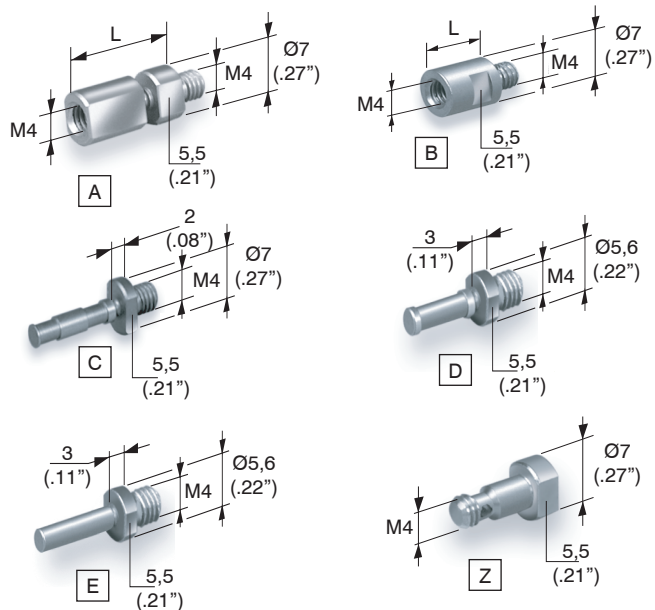

探针护套

描述 mm (inch)	订货号
探针护套	1019108003



探针转接板(杆)

描述	订货号	配合螺丝
转接板 L = 15 mm (.59")	F	1019278028 1019108004
转接板 L = 21,9 mm (.86")	F	1019108036 1019108004
转接板 L = 27,6 mm (1.08")	F	1019108037 1019108004
转接板 L = 40 mm (1.57")	F	1019278006 1019108004
转向杆 L = 10 mm (.39")	G	1019108001 1019108004
转向杆 L = 13,5 mm (.53")	G	1019108002 1019108004
中心座	H	2019108000 -
T型转接杆	N	1019108048 -
T型转接杆配套螺纹座	O	1019108047 -

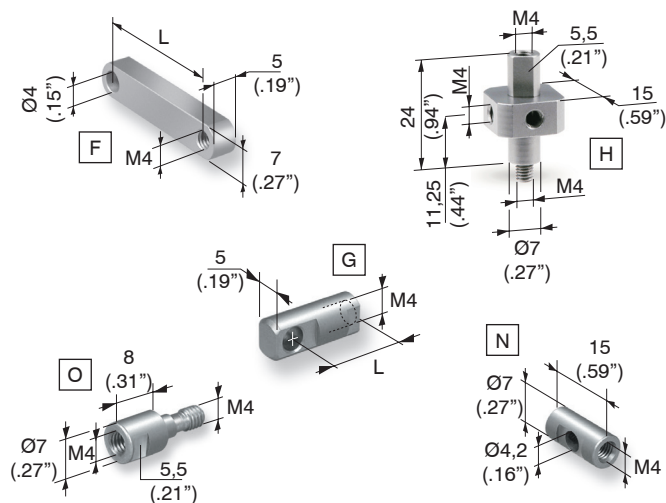

探针转接板(杆)组合示意图

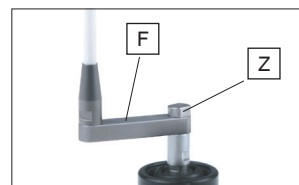
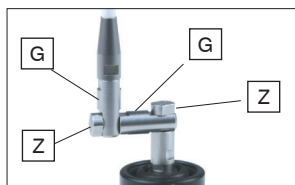
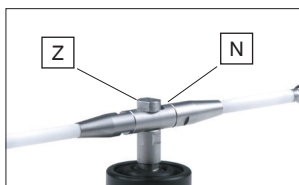
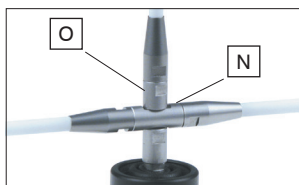

适用附件

保护伞

保护伞可以提供额外的防护铁屑能力

测头	A mm (inch)	B mm (inch)	订货号
T25/TT25/TL25	Ø37 (1.46)	20 (.79)	2015335004
T36	Ø52 (2.05)	25 (.98)	2015340004
T60	Ø75 (2.95)	31.5 (1.24)	2915345013

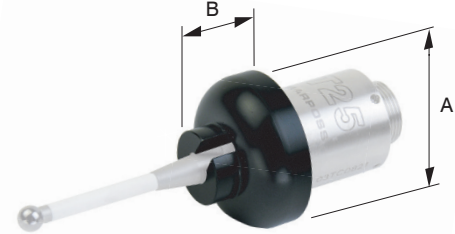

带轴向调整的T25测头安装座

该安装座安装在带孔的固定支架上，使用两个调整螺丝和后背的两个支撑球，使测头轴线在 $\pm 4^\circ$ 内轴向调整。
重量：295g

电缆长度 m (inch)	订货号
6 (236.2)	2915335060

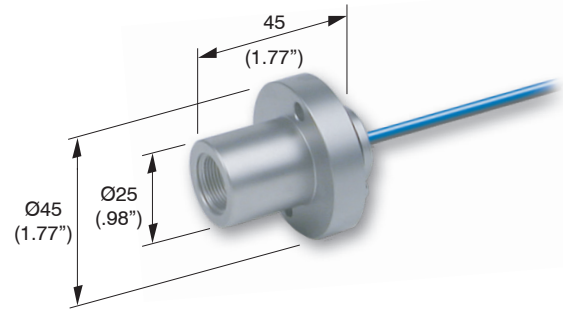

带角度调整的T25测头安装座

该安装座安装在带孔的固定支架上，使用两个沉头顶丝调整，使测头在 $\pm 4^\circ$ 内调整。
重量：130g

电缆长度 m (inch)	订货号
10 (393.7)	2915335070

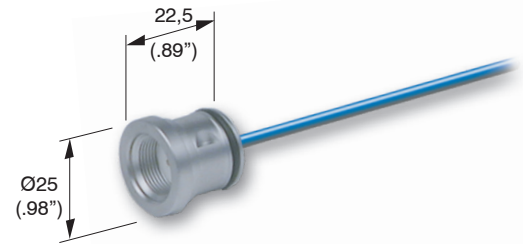

螺纹固定的T25测头安装座

该安装座安装在带有螺纹孔的安装支架上，用扳手拧紧（提供）。
重量：130g

电缆长度 m (inch)	订货号
6 (236.2)	2915335020

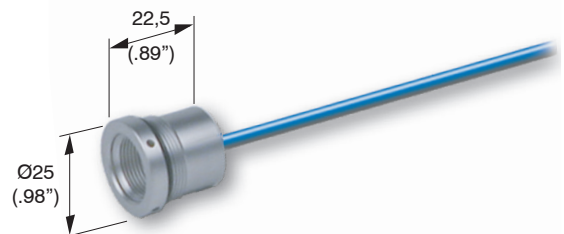

发兰固定式T25 和TT30测头安装座

该安装座安装在带孔的固定支架上，用三个120° 分布的M3螺钉紧固。

重量：150g

Probe	电缆长度 m (inch)	L mm (inch)	D mm (inch)	订货号
T25/TT25/TL25	6 (236.2)	22,5 (.89)	37 (1.46)	2915335010
TT30	6 (236.2)	24,5 (.97)	48 (1.89)	2927877600

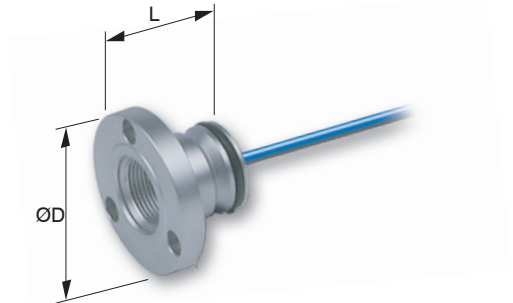

T25测头安装座

该安装座用两个M5螺钉紧固。

重量：210g

电缆长度 m (inch)	订货号
6 (236.2)	2919845005

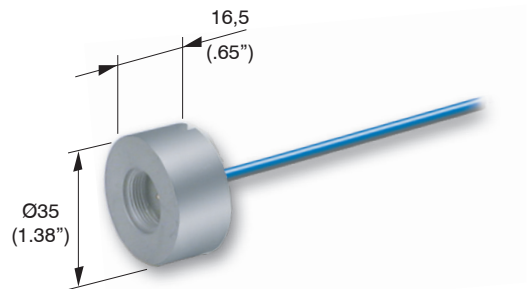

T36测头安装座

该安装座用两个M5螺钉紧固。

重量：160g

电缆长度 m (inch)	订货号
6 (236.2)	2915340100

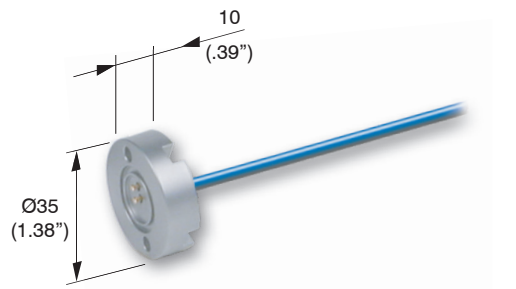

T25/TT25 集成接口安装座

集成接口的安装座插进孔中，触发信号直接由电缆传到CNC

重量：160g

电缆长度 m (inch)	订货号
10 (393.7)	2915335570

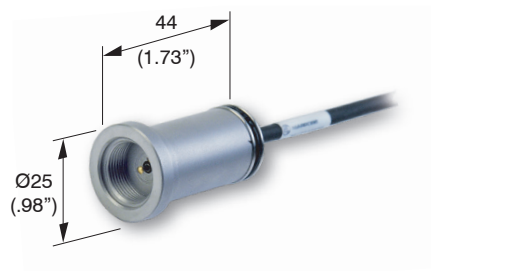

T25测头加长杆

加长杆装在测头和安装座之间，增加测量深度。

L mm (inch)	重量 g		订货号
23,5 (.93)	75	ST	2915335023
50 (1.97)	150	ST	2915335100
100 (3.94)	300	ST	2915335110
150 (5.91)	450	ST	2915335120
150 (5.91)	165	CFK	2915335128
300 (11.81)	208	CFK	2915335129
400 (15.75)	236	CFK	2915335133
500 (19.69)	263	CFK	2915335131
650 (25.59)	308	CFK	2915335132

ST = steel
CFK = carbon fiber

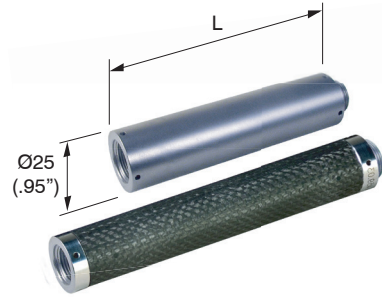

T25测头90° 转向附件

允许在90° 方向的固定轴上使用测头，在340° 位置把它固定在测头安装座上。

重量：305g

类型	重量 g	订货号
一个测头	305	3015335010
两个测头	280	3015335011

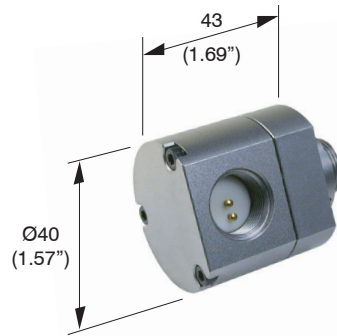

For a full list of address locations, please consult the Marposs official website

D6C06100C0 - Edition 07/2014 - Specifications are subject to modifications
© Copyright 2010-2014 MARPOSS S.p.A. (Italy) - All rights reserved.

MARPOSS, ® and Marposs product names/signs mentioned or shown herein are registered trademarks or trademarks of Marposs in the United States and other countries. The rights, if any, of third parties on trademarks or registered trademarks mentioned in the present publication are acknowledged to the respective owners.

马波斯（上海）商贸有限公司

www.marposs.com

上海：021-61679167
重庆：023-67735200

南京：025-84950111
广州：020-38395796

北京：010-65187548
东莞：0769-85346208

武汉：027-87265450
沈阳：18624099581



Download the latest version
of this document